



# INJECTING INNOVATION

Prototype to low-volume injection molding



*Complete solutions for complex challenges*

# THE SHORTEST ROUTE FROM DESIGN TO PRODUCTION

Quick-turn molded parts – delivered on time, in spec and within budget.

**Shortest lead times** –  
90% of new molds  
completed and sampled  
in four to six weeks

**40+ years  
of expertise**  
building molds and  
injection molding.  
Extensive  
experience with  
over-molding and  
insert molding

**Two locations 30 miles apart** –  
over 80,000 sq. ft. including our  
Engineering Center

**Prō-tō-duction** – Our process  
of moving parts from concept  
to low-volume production

**FastMold®** proprietary  
manufacturing system

***FASTMOLD***®



MEDICAL • AEROSPACE • DEFENSE • PACKAGING • FOOD SERVICE • INDUSTRIAL • CONSUMER PRODUCTS

# ENGINEERING PARTNERSHIP



Communication at every stage – building in quality, efficiency, and differentiation.

## WE SPECIALIZE IN:

- Early involvement
- Design for manufacturing (DFM)
- Dedicated project management
- Full mold design capabilities
- Complex projects
- Remote collaboration (Video conferencing)

## VALUE ADDED:

- Responsive quote turnaround
- 3D printing available
- Prototype injection molded parts

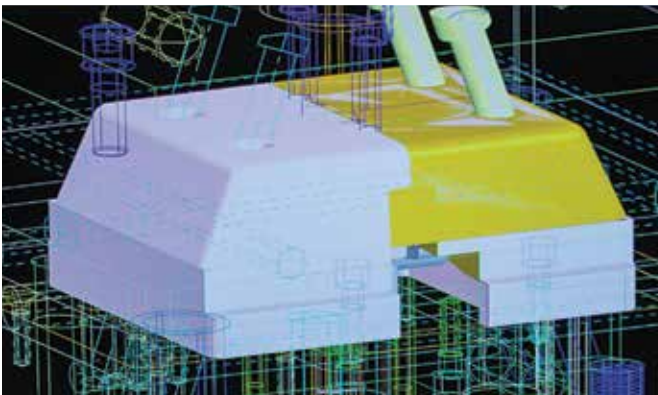

# TOOLING FLEXIBILITY



LIFE OF PROJECT  
MOLD GUARANTEE\*

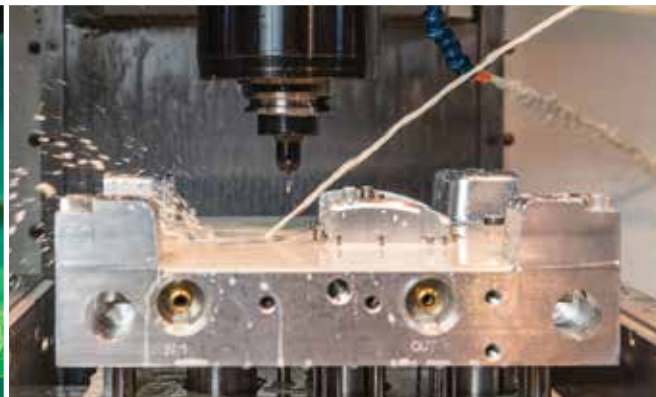

## WE OFFER:

- On site tool room
- Mold builds to meet your project deadline
- Expertise in large, multi-part projects
- FastMold proprietary manufacturing system

## MOLD-MAKING CAPABILITIES:

- Aluminum and steel injection molds/all types
- Prototypes through low-volume production molds

## EQUIPMENT HIGHLIGHTS:

- 16 CNC machines (Including 5-axis)
- 6 Electrical discharge machines (EDM)
  - Makino wire CNC
  - Makino sinker CNC
- 10-ton crane
- Fully equipped tool room

**FASTMOLD®**

# MOLDING EXPERTISE



Leading the way in low volume production.

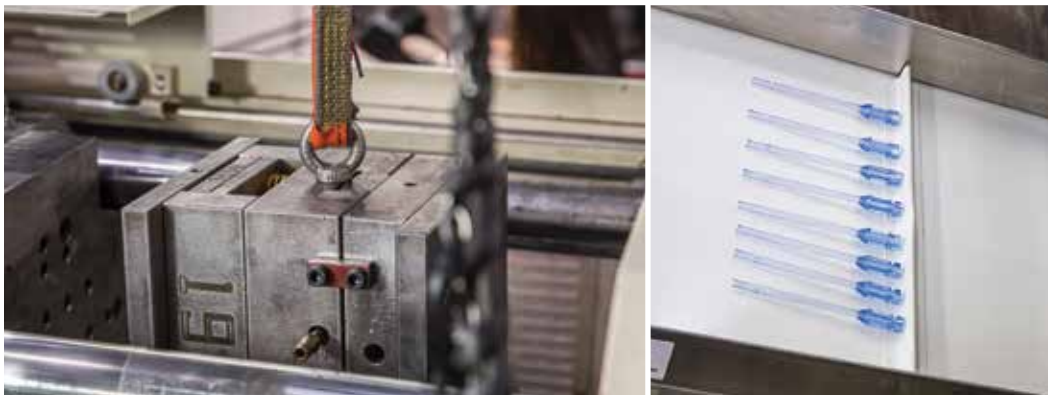

## OUR SPECIALTY:

- Prototype injection molding
- Low-volume production
- Quick mold changes
- Short lead times

## TYPES OF MOLDING:

- Micro molding
- Large parts
- Insert molding
- Over molding

## WE PROCESS:

- All thermal plastic resins

## EQUIPMENT HIGHLIGHTS:

- 31 molding machines (33-ton to 950-ton)
- White room (molding and assembly)
- Clean room (Class 7)

## PROCESS VALIDATION

- Part validation/CPK analysis
- IQ, OQ, PQ
- Tailored to project and customer requirements

# DELIVERING VALUE



Complete quality management  
from design to finished part.



## POST-PRODUCTION SERVICES:

- Assembly
- Sonic welding
- Heat staking
- Thermal/ultrasonic inserting
- Machining and CNC machining
- Ultrasonic cleaning
- Laser marking
- Painting (full decorative painting capabilities)
- EMI/RFI shielding
- Screen printing
- Pad printing

## INSPECTION CAPABILITIES:

- Micro-Vu vision systems
- Optical comparators
- Precision measuring instruments
- Production Part Approval Process (PPAP)
- First article inspection
- In process inspection
- Final inspection

## FULFILLMENT CAPABILITIES:

- Blanket orders
- Consignment orders
- Kanban system orders
- Just-in-time (JIT) system orders